

**YELLOW ANCHOR EYE**  
**ANKERPUNKT GELB**  
**PUNTO DE ANCLAJE DE ALTA VISIBILIDAD**

**Description:**

The Yellow Anchor Eye Fallprotec is permanently installed on a building or other structure to maintain people who are at risk of falling when carrying out maintenance work.

The Yellow Anchor Eye must be assembly with 2 washers DIN9021 12 mm diameter with a M12 bolt in accordance with building structure.

The anchor is mobile on its axis.

**Technical specification:**

Comes with an installer and user manual.

Material: Folded steel plate and an eyepiece of POM (polyoxymethylene) Delrin.

**KN** 17 KN

**KN** >35 KN

Ø 13 mm

 0,28 Kg

**Compliant with EN 795 CLASS A1**

**MADE IN EU** 

**Test certificate n°AT5146195** 

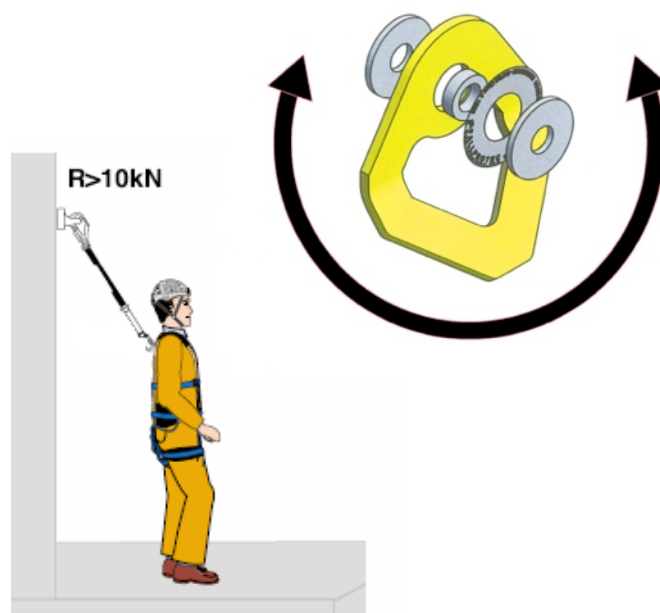
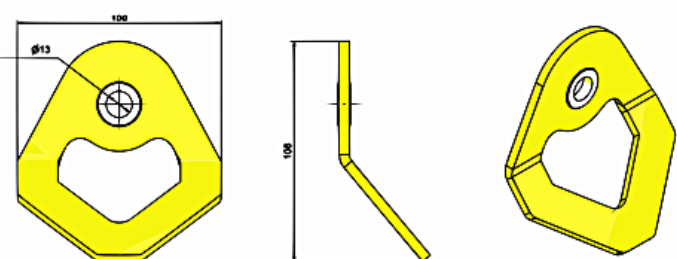

Code N°	Length	Availability
LDV 029	100 x 108 mm	Available from stock



For installations ensure that concrete quality must be at least 25 MPa. Only one user can connect to the anchor point, and the working range has to be within 2 m.